

## Dettaglio fissaggi

**A**

Perno Filettato  
da avvitare



Barilotto da  
serrare in senso  
orario

(seguire il senso  
della freccia)



# 1

SPALLA  
DESTRA

Inserire i perni filettati **A**  
e avvitare fino al completo  
arresto.

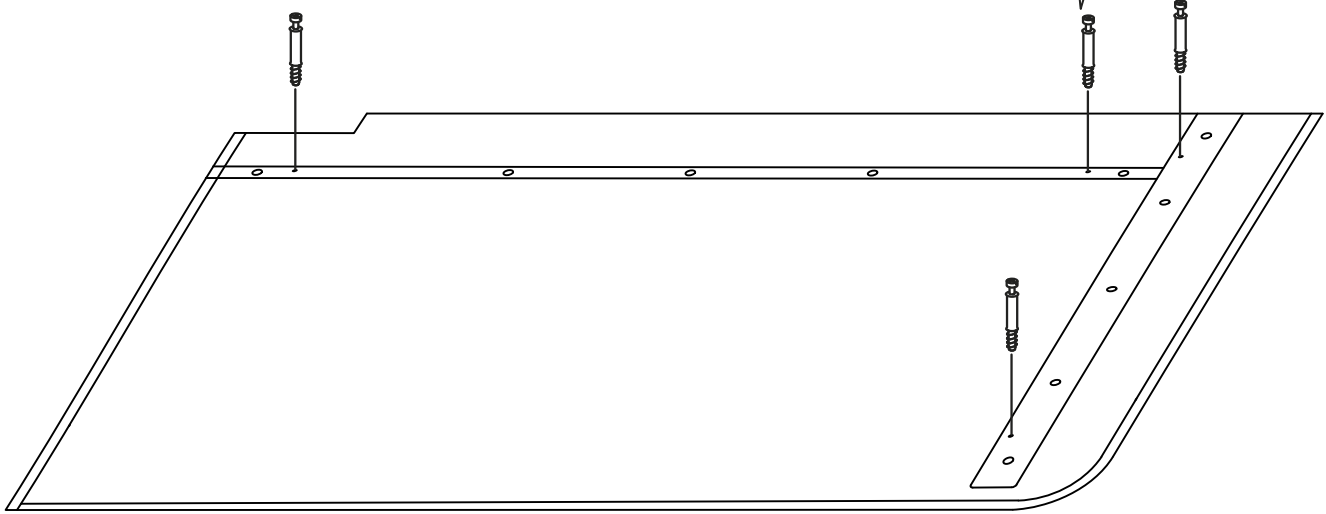
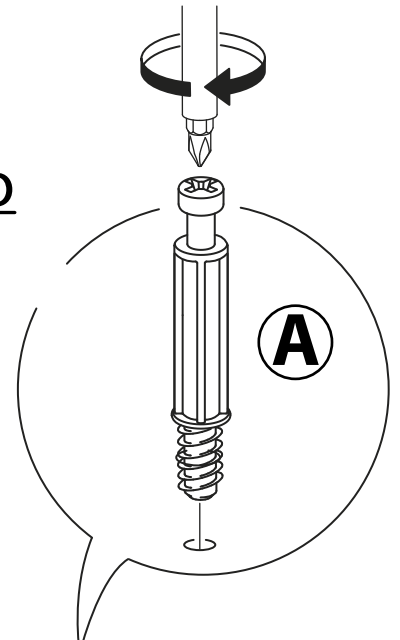

# 2

La spalla destra è pronta.

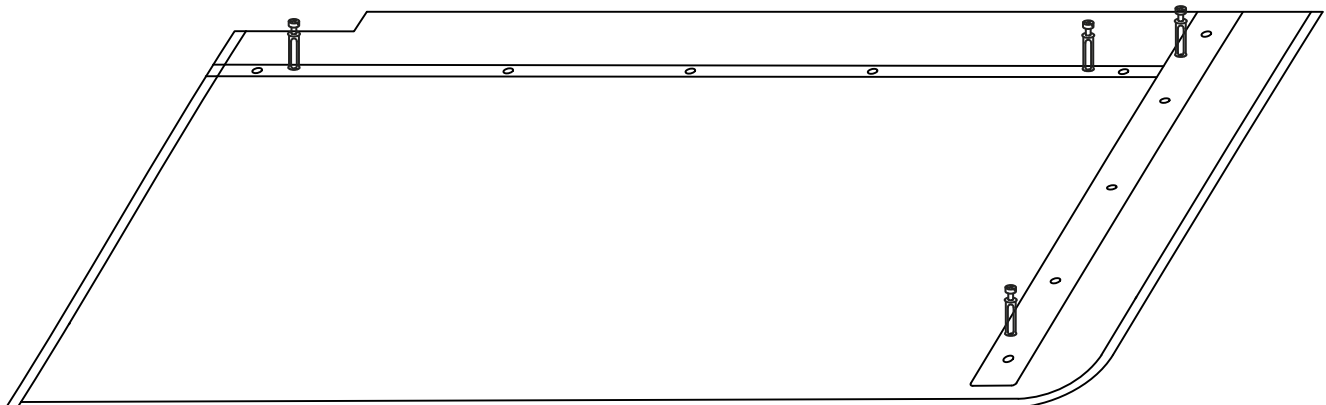

# 3

SPALLA  
SINISTRA

Inserire i perni filettati (A)  
e avvitare fino al completo  
arresto.

La spalla sinistra è pronta.

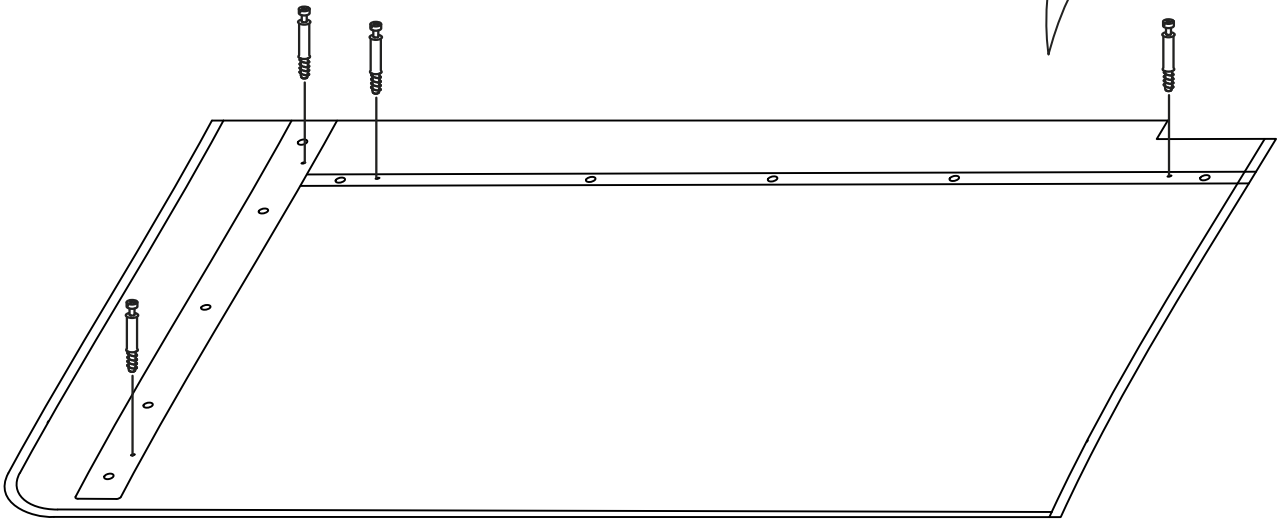
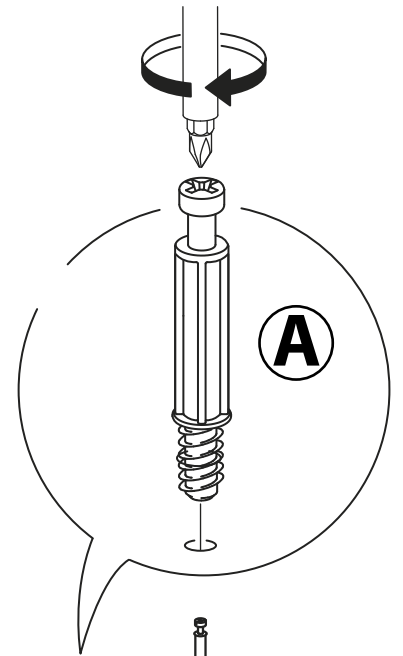

# 4

La spalla sinistra è pronta.

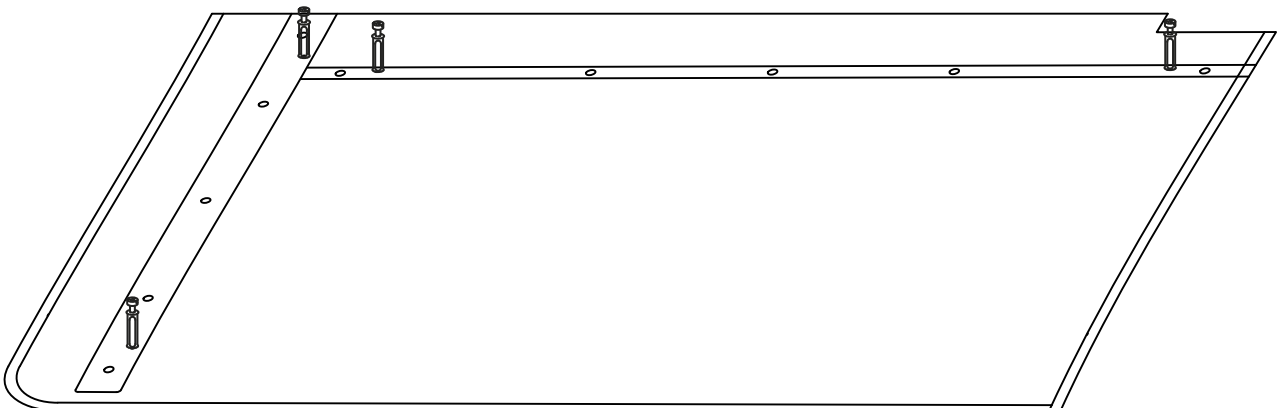

# 5

Inserire le spine in legno per metà della loro lunghezza.

FONDO

SPALLA SINISTRA

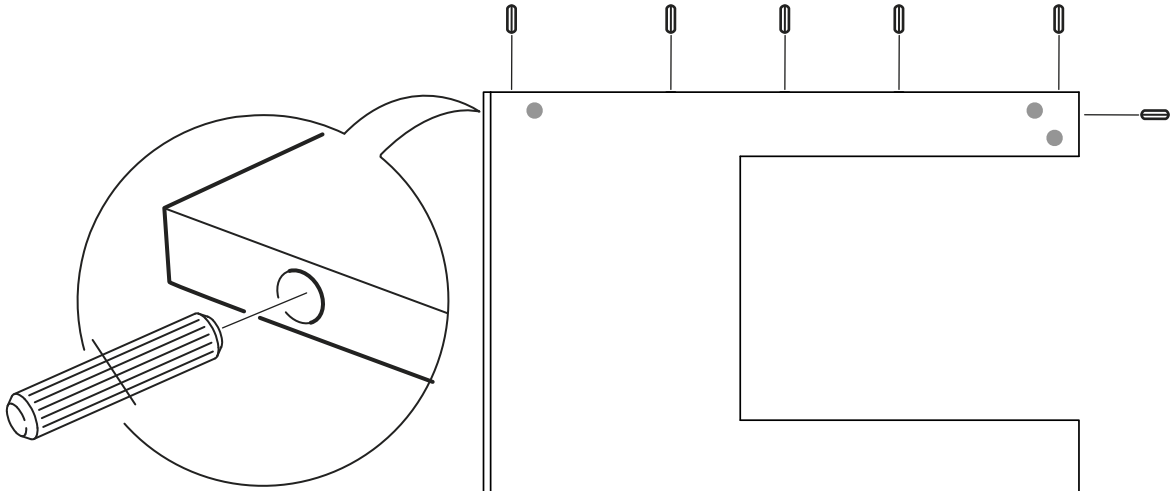

BASSO

ALTO

SPALLA DESTRA



# 6

TOP

Inserire i perni filettati **A**  
e avvitare fino al completo  
arresto.

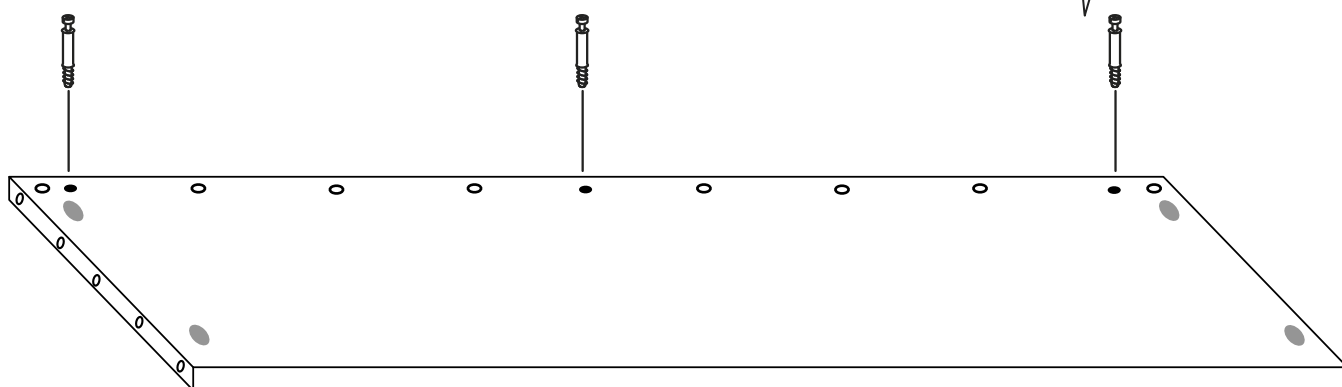
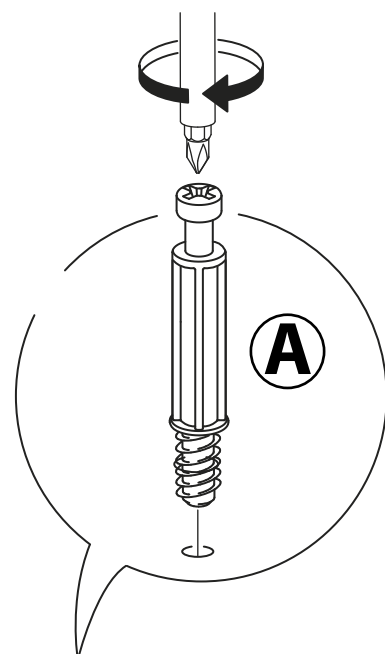

# 7

TOP

Inserire le spine in legno per metà  
della loro lunghezza.

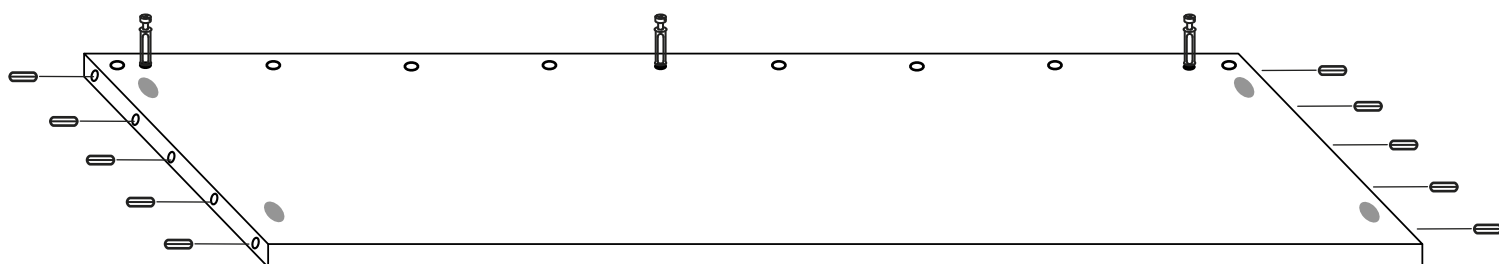

# 8

Assemblare il top sul pannello posteriore.

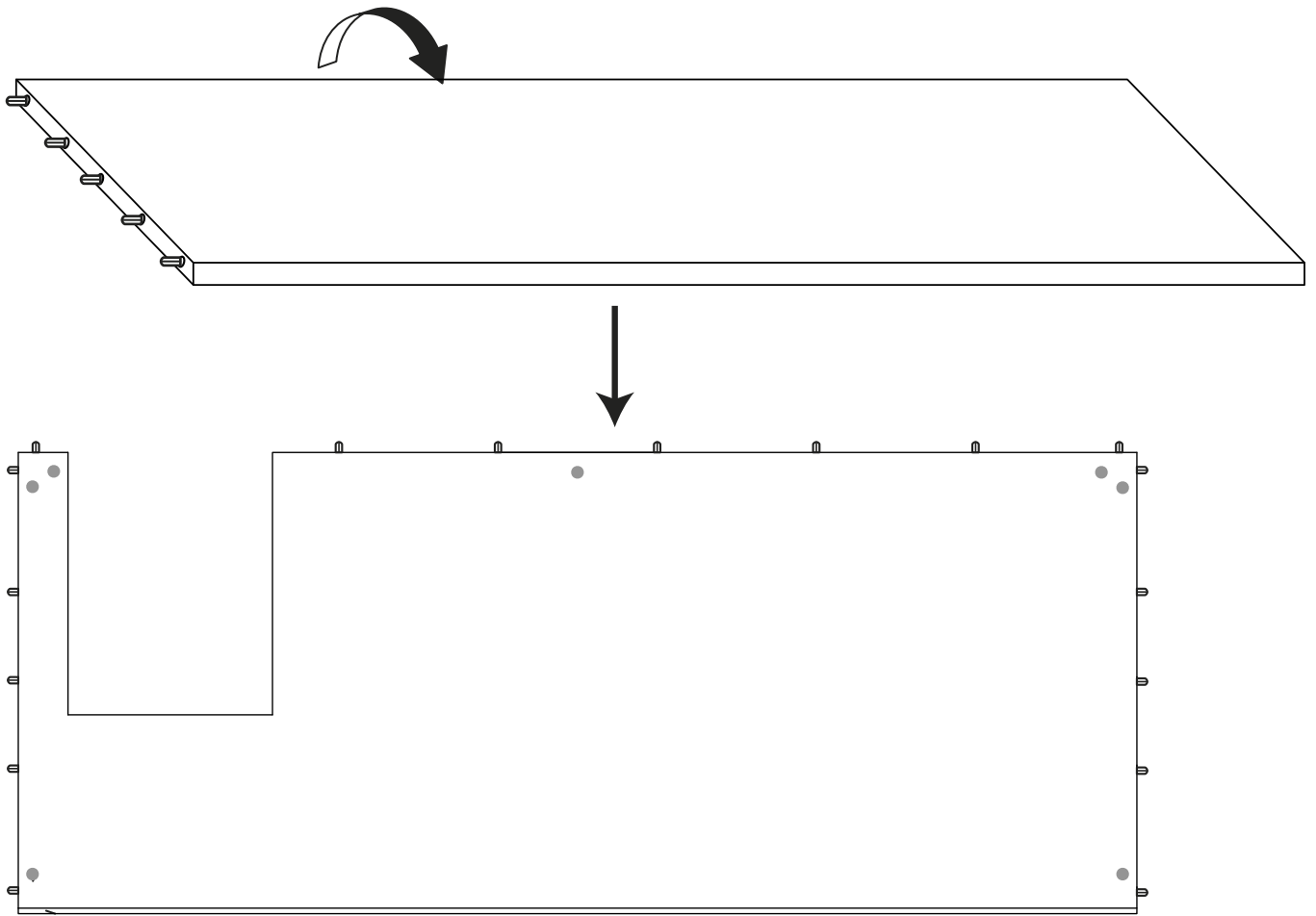

# 9

Inserire i barilotti e serrare ruotando in senso orario.

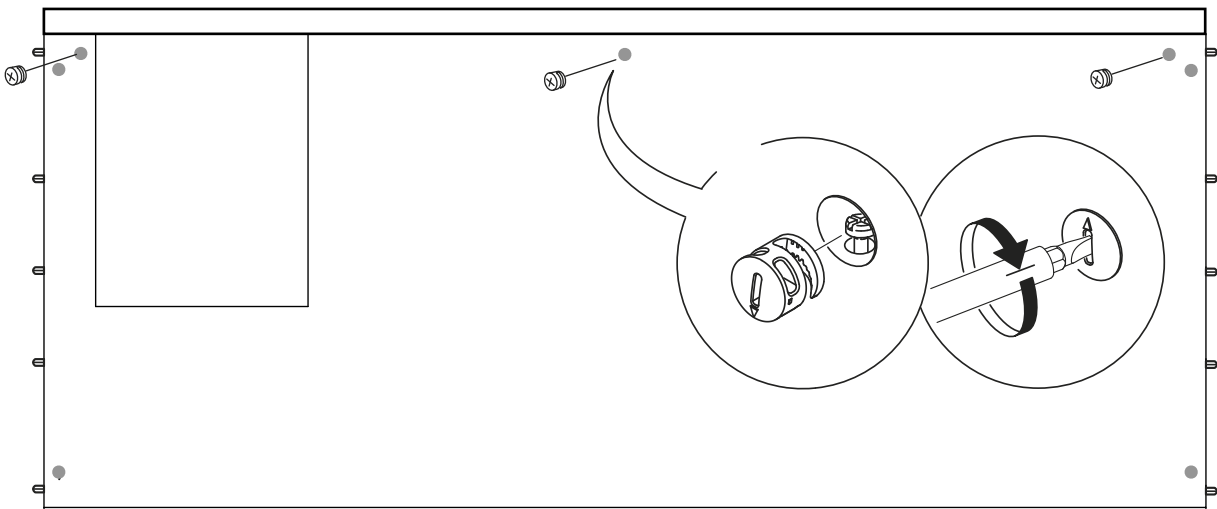

N.B.: i barilotti si inseriscono osservando la freccia verso il perno

# 10 Assemblare la spalla destra facendo coincidere spine e perni nei corrispettivi fori.

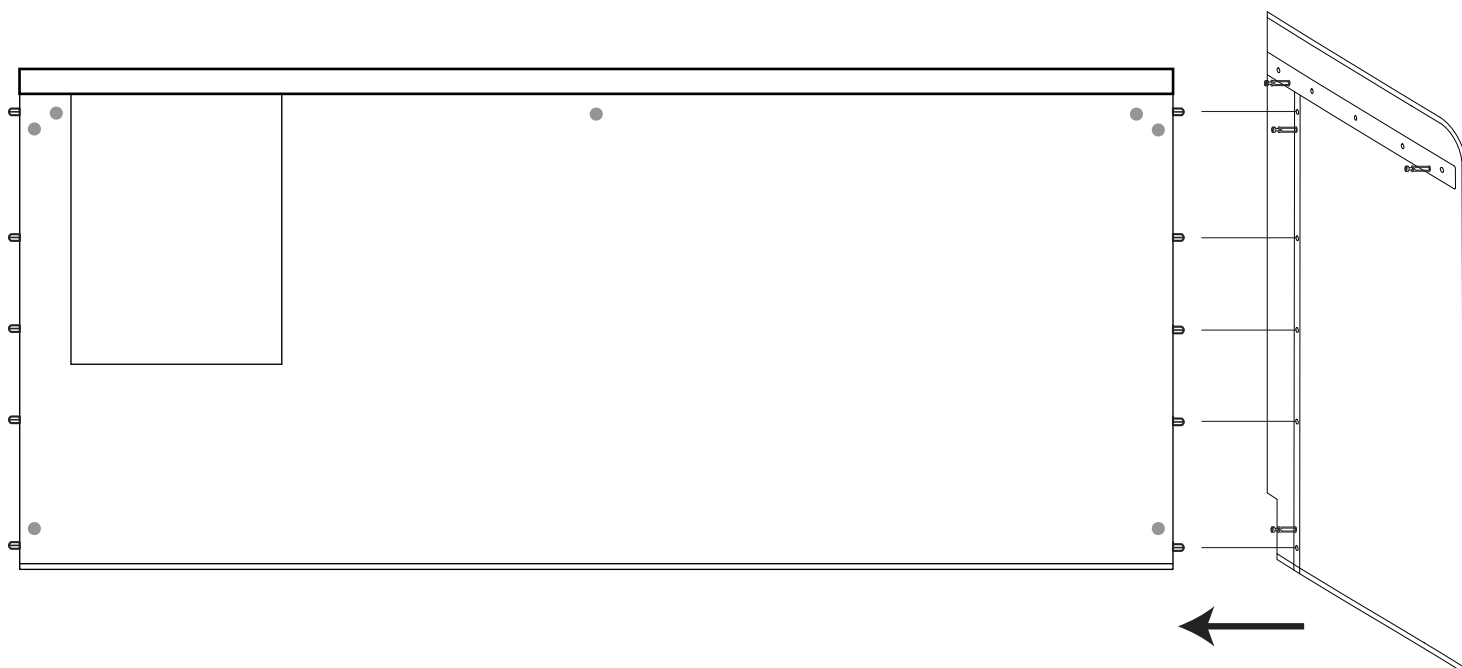

# 11 Inserire i barilotti e serrare ruotando in senso orario.

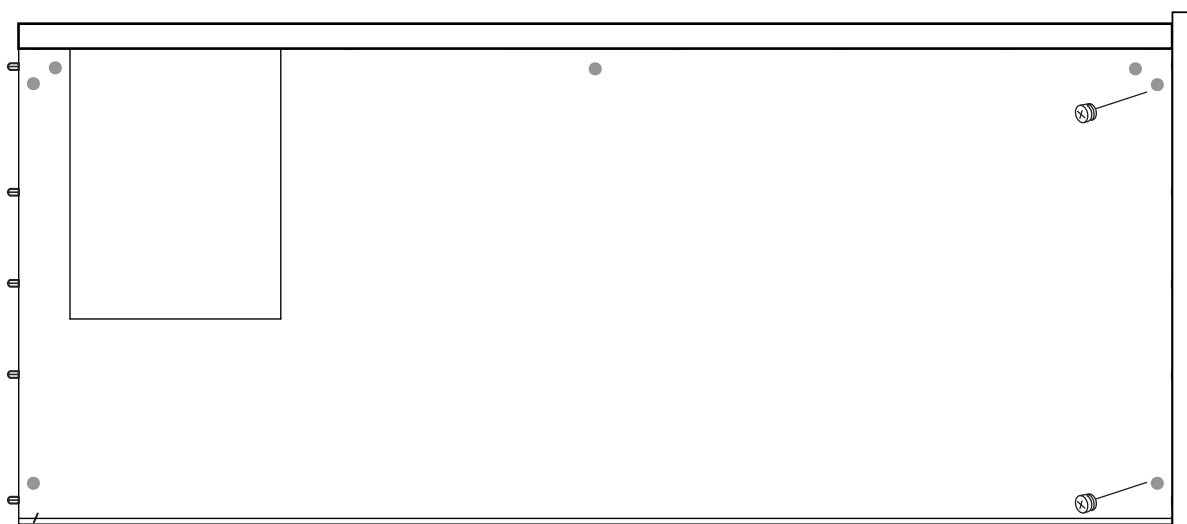

N.B.: i barilotti si inseriscono osservando la freccia verso il perno

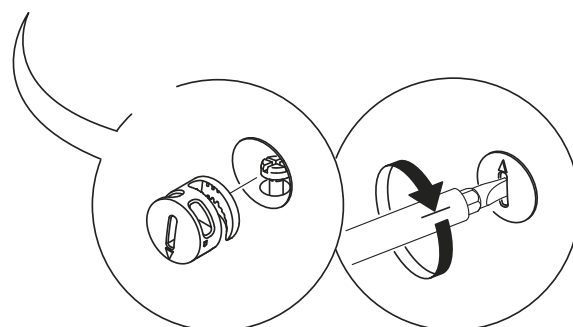

# 12

Assemblare la spalla sinistra facendo coincidere spine e perni nei corrispettivi fori.

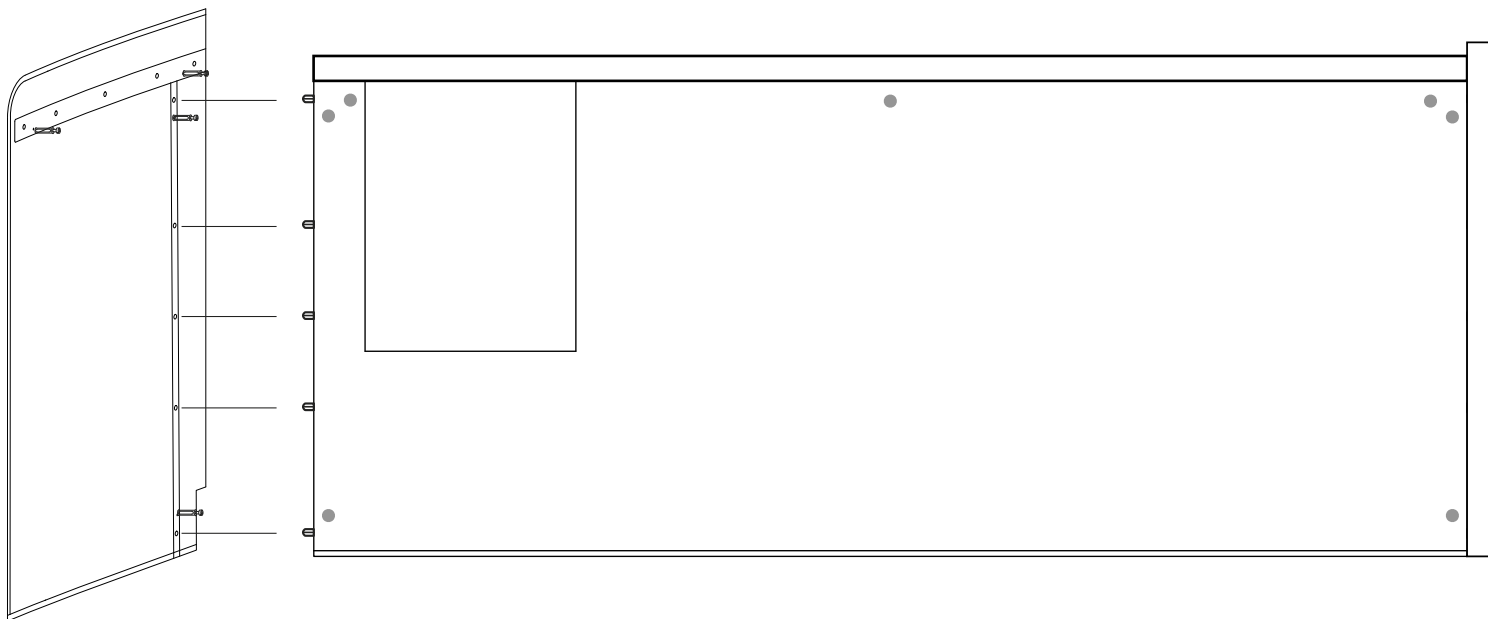

# 13

Inserire i barilotti e serrare ruotando in senso orario.

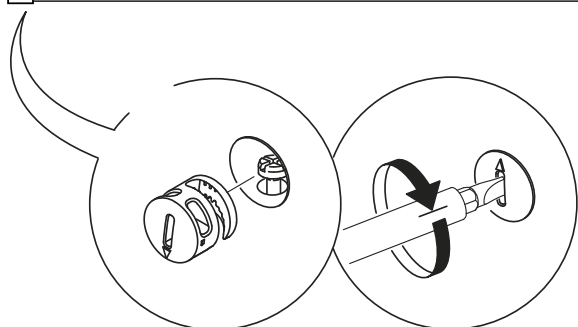
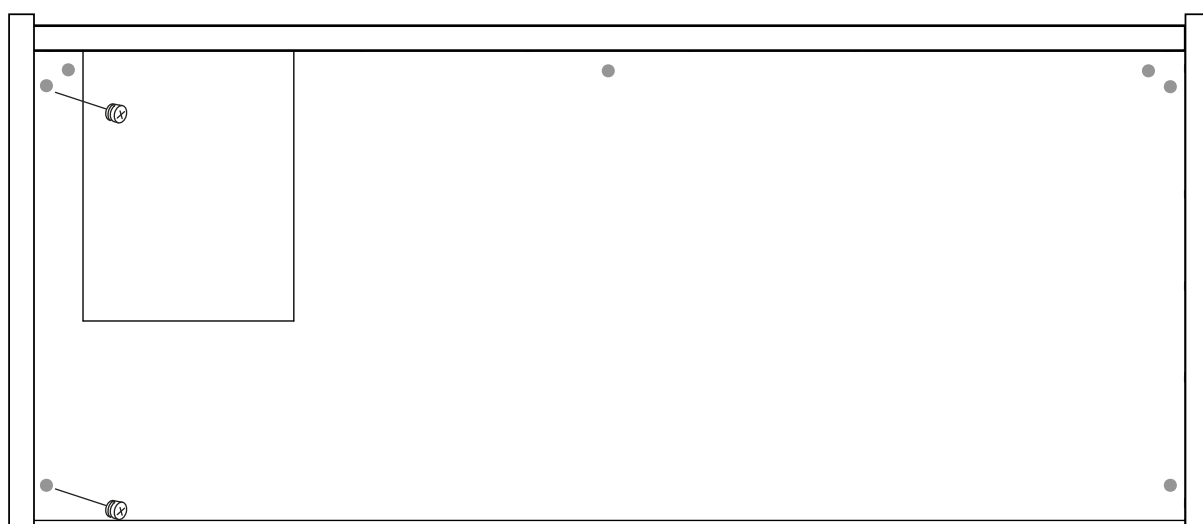

N.B.: i barilotti si inseriscono osservando la freccia verso il perno